

PLYMSTOCK QUARRY S106 APPENDICES
(Plan ref: 07/01094)

Document 2
Schedule 5
APPENDIX 5

**POMPHELETT INDUSTRIAL ESTATE (PIE) TEMPORARY PARKING
PROVISION LAYOUT**

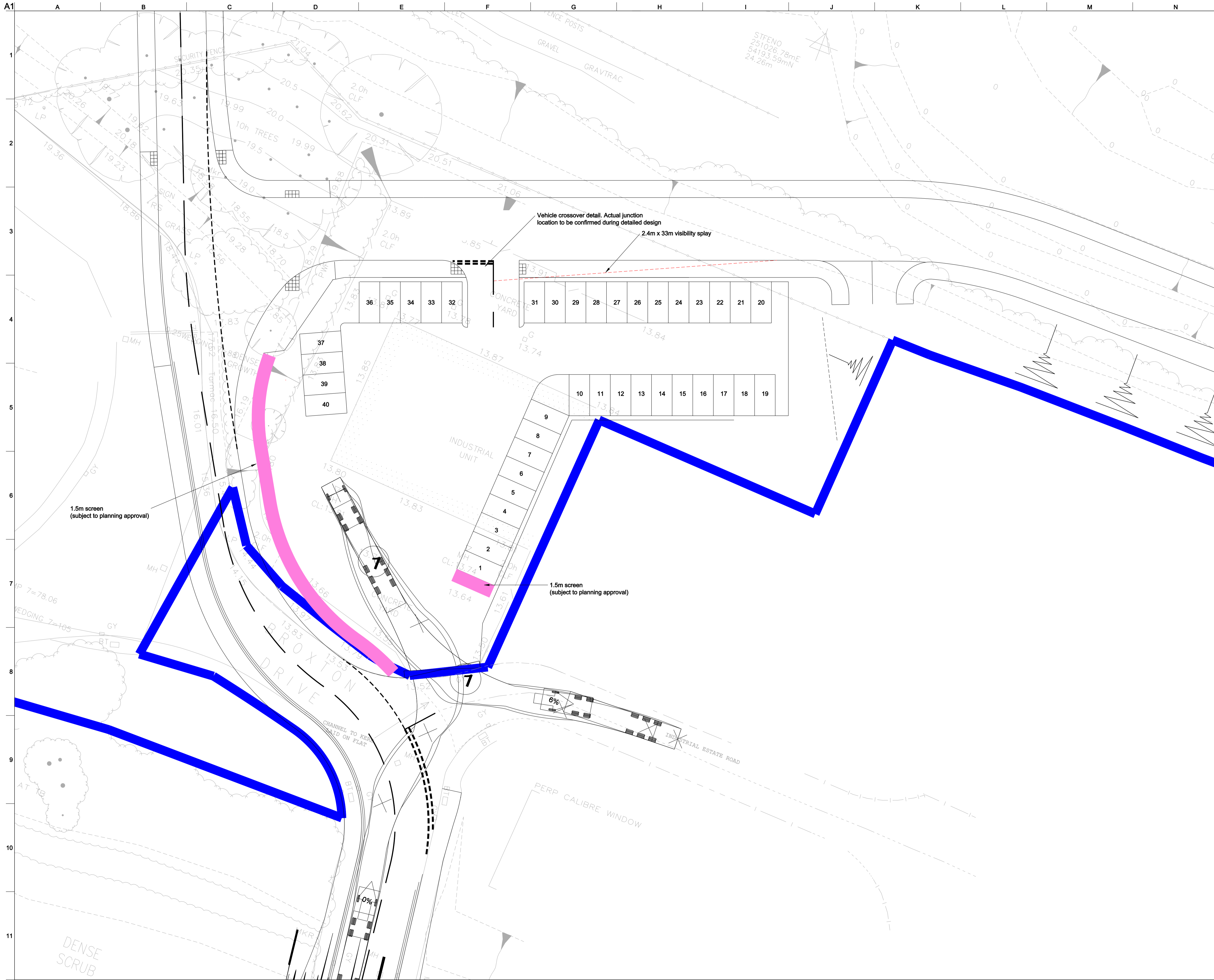

- Notes:
1. Persimmon already possess the ability to ensure PIE estate road is not obstructed.
 2. New PIE parking area managed by Persimmon so as to prevent misuse for example by Persimmon contractors.
 3. HGV manoeuvring area for HGV's only.
 4. Either fence or screen wall (to be approved by Plymouth City Council).

06	25/11/10	SJB	JCL	JCL
Note removed				
05	12/10/10	SJB	JCL	
Car park amended to new layout				
04	06/10/10	SJB	JCL	JCL
Car parking layout amended to accommodate HGV U-turn				
03	05/08/10	SJB	JL	JL
Notes added				
02	29/07/10	RD	JCL	JCL
Car Park Access Relocated				
Issue	Date	By	Chkd	Appd

ARUP

63 St Thomas Street
 Bristol BS1 6JZ
 Tel +44(0)117 976 5432 Fax +44(0)117 976 5433
 www.arup.com

Client
**Persimmon Strategic Projects
 South West**

Job Title
**Planning Application for
 Redevelopment of
 Plymstock Quarry**

Drawing Title
P.I.E. Parking Provision

Scale at A1 1:200
 Plot ID
 Drawing Status
Planning

Job No 122087	Drawing No CH-203	Issue 06
-------------------------	-----------------------------	--------------------

J:\22000\122087-004_30_Drawing_Live_Drawing\122087-004-CH-203.dgn